

Crown Royal Blackberry Display (UCRR01718) | Assembly Instructions



Hardware:

(4) black bolts, (1) Allen wrench, (8) washers, (8) wing-nuts, (4) short silver bolts, (4) long silver bolts, (2) push fasteners.

Parts:

(1) base, (1) canopy/graphic panel, (1) shelf (2) side panels, (1) center support, (1) base sign, (4) pole sections, (2) shelf patches

The assistance of another person may be required for some steps.



1) Place the base on a flat level floor in the desired location.

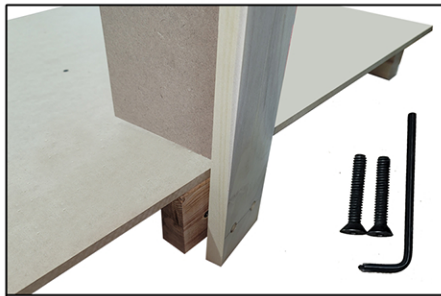

2A) Take the center support and align with the wood block in the back of the base.
2B) Insert 2 black bolts and use Allen wrench to tighten firmly.



3A) With the center support in place, take the shelf and align holes in both pieces and rest in place.
3B) Insert 2 black bolts and use Allen wrench to tighten firmly.



4A) Take the side panel and aligned with base blocks on the side. Art faces outward. **4B)** Insert 2 long silver bolts. **4C)** To secure use 2 wing-nuts from under the base. Repeat for other panel.

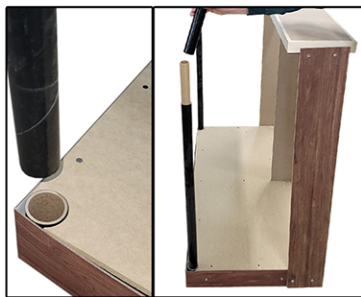

5) Take the pole section with exposed end up and insert into the base. Repeat for other pole.



6) Take canopy/graphic panel and fold up the shelf and place on top. The tabs should go over the edge of the shelf.

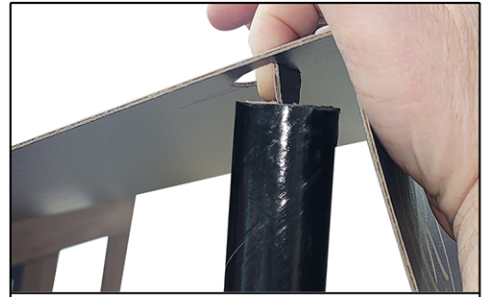

7) Fold canopy over top the poles and push down the tab to insert into the pole. This will hold the panel in place.



8A) Fold the ends of the shelf panel down and place the side panels against.
8B) Insert short silver bolts and secure using wing-nuts under the shelf.



9) Fold the front edge down and insert the tabs backwards into itself on either end.

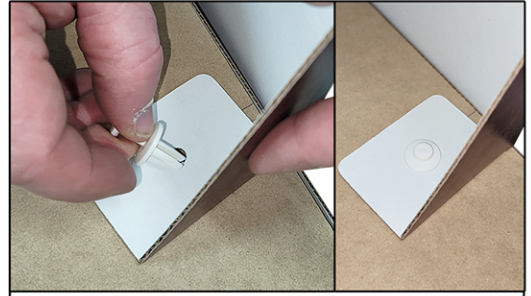

10) Take base sign and fold flaps back. Align holes with the holes in the base. Insert the two white push fastener and push down until flush to secure.



11) Remove the adhesive backing and place the two shelf patches into the open sections of the corrugated panel.



12) Assembly is not complete and the display can be stocked with product.

Please Note:
The base sign can/should be removed for easy loading of cases.

DO NOT MOVE DISPLAY WITH PRODUCT ON IT